

**PASSENGERS FLIGHTS FROM SANAE IV TO SA AGULHAS
(2003/2004 SUMMER SEASON)**

INFORMATION

- Pay attention to the pre-flight safety briefing.
- **Note** - the point of operation for the aircraft will be the SA Agulhas.
- You will be informed *timeously* by the DCO or ADCO, *Angelo van Niekerk* or *Franz Hoffmann* as to when the first flight to SA Agulhas will take place.
- After the flight schedule has been announced *all* personal luggage must be taken to the hanger 30 minutes prior to the commencing of flight operations.
- Clearly *mark* all your luggage with your name for easy identification once it arrives at SA Agulhas.
- The flight time to SA Agulhas is approximately forty five minutes.
- Flights from SA Agulhas – SANAE – SA Agulhas will take approximately 2 hours. The second aircraft will be used for personal luggage only and will take off approximately 30 minutes after the first passenger flight.
- It is important to wait for the signal from the Flight Engineer before disembarking and remember to disembark towards the front of the aircraft.

NB:

- On passenger flights, only **hand luggage** is permitted (e.g. *laptops, cameras, sleeping bags and a change of clothes* - in the event of luggage flights being delayed due to bad weather).
- All personal luggage will be flown on dedicated luggage flights.
- Under no circumstances are the air crew to be approached with special requests, only the DCO can authorise such requests.

For your information:

1. The SAAF will fly to the ship on the 04th February 2004 to back-load their pack up kit (both Oryx's will be used for this exercise).
 - Oryx one will fly all pack up kit and SAAF personnel to SA Agulhas to assist with the back loading of SAAF equipment.
 - Oryx two will fly from SANAE – E-base – Ship (Shorty will be dropped off at E-Base and picked up later when aircraft returns to SANAE (the same day). Refer to flight schedule of passengers that will be flown on the 4th February 2004 back to the ship.
 - **NOTE:** After completing the flight operations for the day both Oryx's will return to SANAE.
2. On the 5th February 2004 both aircraft will fly to the ship and remain on board (ship will then be point of operation for flight ops).
3. All remaining SANAE based personnel will be flown to the SA Agulhas on the 6th February 2004.
4. *Christine Hanel* will travel via Cat Train to E-base on the 5th or 6th February for her final E-base audit.

End of page one

| - FLIGHT SCHEDULES - | | |
|----------------------|--|----------|
| FLIGHTS | PASSENGER OR LUGGAGE FLIGHT | Aircraft |
| | 06 th February 2004 (Times to be announced) | |
| Flight one | SAAF personnel and own personnel | Oryx one |
| Flight two | Passengers and all personal Luggage (SAAFS & SCIENTISTS) | Oryx two |

On the 5th February 2004 both Oryx's and SAAF personnel will fly to the SA Agulhas, the vessel will then become their (SAAF) point of operation.

| - FLIGHT SCHEDULES - | | |
|----------------------|---|----------|
| FLIGHTS | PASSENGER OR LUGGAGE FLIGHT | Aircraft |
| | 06 th February 2004 (Times to be announced) | |
| Summary Flight | German Scientist to Neumayer Base | Oryx one |
| Flight one | Passenger flight with hand luggage (SAAE 43) | Oryx two |
| Flight two | Personal luggage flight for above flight (flight one) | Oryx one |
| Flight three | Passenger flight with hand luggage (NDPV) | Oryx two |
| Flight four | Personal luggage flight for above flight (flight three) | Oryx one |
| Flight five | Passenger flight with hand luggage (DEAT & SCIENTISTS) | Oryx two |
| Flight six | Personal luggage flight for above flight (flight five) | Oryx one |

- FLIGHT NAME LISTING -

27th February 2004 (Times to be announced)

| FLIGHT | OBJECTIVE | NAME'S | AIRCRAFT |
|------------|-------------------------------------|--|----------|
| Flight one | ALL pack up and own personal | N/A | ORYX ONE |
| Flight two | Passengers and all personal luggage | J. van der Merwe Prof. A. Hester A. Avstad R. Lewis R. Mulder P. Bezuidenhout | ORYX TWO |

On the 2nd February 2004 both Oryx's will fly to the SA Agulhas which will then become their point of operation

28th February 2004 (Times to be announced)

| FLIGHT | OBJECTIVE | NAME'S | AIRCRAFT |
|-----------------|--|---|----------|
| Neumayer flight | Two Submersible to be flown to Neumayer Station (will return to SAAGAS to commence with Oryx two) | N/A | ORYX ONE |
| Flight one | Passenger flight with hand luggage | D. Kozlov E. Ferreira K. Steyn N. Janse van Rensburg J. Sells T. Hyatt V. Masood M. Sengala J. van Ruyven | ORYX TWO |
| Flight two | Personal luggage flight for flight one | Personal luggage | ORYX ONE |
| Flight three | Passenger flight with hand luggage | D. Hesthouse V. Fichouet H. Smith E. Williams R. Sussner R. Sells C. Ng A. Stimpsher J. Frost A. Demirel | ORYX TWO |
| Flight four | Personal luggage flight for flight three | Personal luggage | ORYX ONE |
| Flight five | | A van Niekerk D. Widdows S. Durand K. Meyer J. Pater Huisman A. Mars L. du Plessis F. Hoffmann | ORYX TWO |
| Flight six | Personal luggage flight for above flights (flight five) | Personal luggage | ORYX ONE |

- FLIGHT SCHEDULES -

February 2004 (Times will be announced)

| FLIGHTS | DESCRIPTION | PERSONNEL | STATUS |
|-----------------|--|---|----------|
| Neumayer flight | Two Scientist to be flown to Neumayer Station (Aircraft will return to SANAE) | N/A | ORYX ONE |
| Flight one | Passenger flight with hand luggage | D. Ritchie E. Ferreira K. Steyn N. Janse van Rensburg J. Bijker T. Nyembe V. Masodo M. Sekgala J. van Rooyen | ORYX TWO |
| Flight two | Personal luggage flight for <u>flight one</u> | Personal luggage | ORYX ONE |
| Flight three | Passenger flight with hand luggage | D. Hendrikse V. Rinquest H. Smith E. Williams R. Bassadien R. Salle C. Nel A. Strümpher J. Frost A. Damster | ORYX TWO |
| Flight four | Personal luggage flight for <u>flight three</u> | Personal luggage | ORYX ONE |
| Flight five | | A van Niekerk R. Muscheler D. Windwaal S. Durand N. Meyer R. Lewis Prof. A. Hussin C. Hanel J.R van der Merwe A. Ahmad | ORYX TWO |
| Flight six | Personal luggage flight for <u>above flight (flight five)</u> | Personal luggage | ORYX ONE |
| Flight seven | Passengers and remaining personal Luggage | J. Petter Hoias A. Mans L. du Plessis F. Hoffmann | ORYX TWO |

END OF PAGE FOR FLIGHT SCHEDULES

VOYAGE SCHEDULE

Annexure B

SA AGULHAS ~ 2003/04

PRE-DEPARTURE

| | | |
|-----------------------------|-----------------------|--------|
| 1 + 2 December 2003 | Load vehicles | 2 Days |
| From 03 to 09 December 2003 | Load cargo | 7 Days |
| 06 + 07 December 2003 | Take fuel (for SANAE) | 2 Days |
| 07 + 08 December 2003 | Helicopters onboard | 2 Days |

VOYAGE 114

| DEPART | ARRIVE | ACTION | DURATION |
|---|---------------------------------------|---|---------------------------------|
| 10 December 2003 (ETD Cape Town 14:00) | 25 December 2003 ETA - Antarctica | Voyage to Antarctica | 15 Days |
| Blank | 15 December 2003 (Bouvet Island) | Service of AWS (Norwegian) Back load of cargo | 24 Hours |
| 16 December 2003 (Bouvet Island) | Blank | Depart to Norwegian off-loading point (5 Deg East) | Approximately 5 days Sailing |
| | 21 December 2003 (ETA 5 Deg East) | Off-load approx 42 tons of Norwegian cargo | 48 Hours |
| 23 December 2003 (Depart for SANAE) | 25 December 2003 (Arrive at SANAE) | Blank | 2 Days |
| 25 December 2003 - 07 January 2004 (SANAE) | | Off-load cargo Off-load personnel Pump fuel | 14 Days |
| 08 January 2004 (ETD SANAE) | 18 January 2004 (ETA SANAE) | SAWB buoy deployment South Sandwich Islands | 10 days |
| 18 January 2004 to 8 - 10 February 2004 | | Back-load cargo Pump fuel Back-load passengers | 20 - 22 days |
| 8 - 10 February 2004 (ETD SANAE) | 18 February 2004 (ETA Cape Town) | Voyage to Cape Town | 8 - 10 Days |

TOTAL DURATION OF RELIEF VOYAGE:

TOTAL: 71 DAYS

PASSENGER LIST

Department of Environmental Affairs and Tourism

| | | |
|------------------------|---|--|
| Mr. A. van Niekerk | - | Departmental Co-ordinator |
| Mr. F. Hoffmann | - | Assistant Departmental Co-ordinator / Electronics Technician |
| Mr. J. Pietersen | - | Mechanical Leader |
| Ms S. Durand | - | Administration Officer |
| Mr. D. Windwaai | - | Assistant Administration Officer |
| Ms C. Hanel | - | Environmental Officer |
| Mr. Z. Botha | - | Medical Orderly |
| A. N other | - | Medical Technician |
| Mr. P. J. Bezuidenhout | - | Chaplain |
| Mr. N. Meyer | - | Chef |
| Mr. E. Mathys | - | Chef |
| Mr. L.S.D. du Plessis | - | Diesel mechanic/driver |
| Mr. G. Harper | - | Diesel Mechanic/driver |
| Mr. J. Skelete | - | Diesel Mechanic/driver |
| Mr. A. Masshilo | - | Diesel Mechanic /driver |
| Mr. J. Taljaard | - | Diesel Mechanic/ driver |
| Mr. A. Kietzmann | - | Diesel Mechanic/ driver |
| Mr. D.C. van Zyl | - | Dozer |
| Mr. S. Ndaba | - | Dozer |
| Mr. I. Gouvias | - | Barlows Mechanic |
| Mr. R. Lewis | - | Field operator |
| Prof. Dr. Azhar Hussin | - | Malaysian (Scientist) |
| Mr. Amirrudin Ahmad | - | Malaysian (Scientist) |

National Department of Public Works

| | | |
|------------------|---|--------------|
| Mr. D. Hendrikse | - | Group Leader |
| Mr. V. Rinquest | | |
| Mr. H. Smith | | |
| Mr. E. Williams | | |
| Mr. R. Bassadien | | |
| Mr. R. Salie | | |
| Mr. C. Nel | | |
| Mr. A. Strumpher | | |
| Mr. J. Frost | | |
| Mr. A. Damster | | |

South African Air Force

| | | |
|---------------------|---|--------------|
| Maj B. Bell | - | Group Leader |
| Maj G. Sproul | | |
| Maj J. Redelinghuys | | |
| Lt T. Kuipers | | |
| Lt J. du Preez | | |
| WO E. Rice | | |
| F/Sgt F. Boekkooi | | |
| F/Sgt J. Sindin | | |

Sgt P. Jacobs
Sgt Y. Samuel
Sgt M. Xalagube
Sgt P. Zaayman
WO L. le Roux
Cpl G. Dreyer

South African Weather Services

Mr J R vd Merwe - Group Leader

Scientist - University of Potchefstroom

Mr. L. du Plessis - Group Leader
Ms A. Mans
Mr. R. Muscheler

SANAE 43 Expedition Team

(Team to over-winter at SANAE IV)
Mr. B. de Wet - Team Leader and Electronics Technician
Mr. S. Terblanche - Meteorologist
Mr. S. Cockcroft - Physicist
Mr. P. Wolmerans - Physicist
Mr. L. Engelbrecht - Electrical Technician
Mr. M. Welgemoed - Diesel Mechanic
Mr. D. Gouvias - Diesel Mechanic
Dr. R. Niemand - Doctor
Mr. M. Loubser - Mechanical Technician

International participants

Mr. Jaakko Mäkinen - (Not returning to RSA on SA Agulhas)
Mr. Jan Tore Johansen - (Disembark at 5 Deg East)
Mr. Øystein Mikelborg - (Disembark at 5 Deg East)

International participants

Mr. Jan Petter Høiaas - (Returning to RSA on SA Agulhas)

SANAE 42 Expedition Team

(Returning to RSA on SA Agulhas)
Mr. D. Ritchie - Team Leader and Diesel Mechanic
Mr. E. Ferreira - Electronics Technician
Mr. K. Steyn - Meteorologist
Mr. N. Janse van Rensburg - Physicist
Mr. J. Bijker - Physicist
Mr. T. Nyembe - Electrical Technician
Mr. V. Masodo - Diesel Mechanic
Dr. M. Sekgala - Doctor
Mr. J. van Rooyen - Mechanical Technician

TOTAL PARTICIPANTS

**63 en-route to Antarctica
61 return voyage to Cape Town**

VOYAGE SCHEDULE**SA AGULHAS ~ 2003/04****PRE-DEPARTURE**

| | | |
|-----------------------------|-----------------------|--------|
| 1 + 2 December 2003 | Load vehicles | 2 Days |
| From 03 to 09 December 2003 | Load cargo | 7 Days |
| 06 + 07 December 2003 | Take fuel (for SANAE) | 2 Days |
| 07 + 08 December 2003 | Helicopters onboard | 2 Days |

VOYAGE 114

| DEPART | ARRIVE | ACTION | DURATION |
|---|---|---|---------------------------------|
| 10 December 2003 (ETD Cape Town 14.00) | 25 December 2003 ETA - Antarctica | Voyage to Antarctica | 15 Days |
| Blank | 15 December 2003 (Bouvet Island) | Service of AWS (Norwegian) Back load of cargo | 24 Hours |
| 16 December 2003 (Bouvet Island) | Blank | Depart to Norwegian off-loading point (5 Deg East) | Approximately 5 days Sailing |
| | 21 December 2003 (ETA 5 Deg East) | Off-load approx 42 tons of Norwegian cargo | 48 Hours |
| 23 December 2003 (Depart for SANAE) | 25 December 2003 (Arrive at SANAE) | Blank | 2 Days |
| | 25 December 2003 - 07 January 2004 (SANAE) | Off-load cargo Off-load personnel Pump fuel | 14 Days |
| 08 January 2004 (ETD SANAE) | 18 January 2004 (ETA SANAE) | SAWB buoy deployment South Sandwich Islands | 10 days |
| | 18 January 2004 to 8 - 10 February 2004 | Back-load cargo Pump fuel Back-load passengers | 20 - 22 days |
| 8 - 10 February 2004 (ETD SANAE) | 18 February 2004 (ETA Cape Town) | Voyage to Cape Town | 8 - 10 Days |

TOTAL DURATION OF RELIEF VOYAGE:

TOTAL: 71 DAYS

VOYAGE SCHEDULE**SA AGULHAS ~ 2003/04****PRE-DEPARTURE**

| | | |
|-----------------------------|-----------------------|--------|
| 1 + 2 December 2003 | Load vehicles | 2 Days |
| From 03 to 09 December 2003 | Load cargo | 7 Days |
| 06 + 07 December 2003 | Take fuel (for SANAE) | 2 Days |
| 07 + 08 December 2003 | Helicopters onboard | 2 Days |

VOYAGE 114

| DEPART | ARRIVE | ACTION | DURATION |
|---|---|---|---------------------------------|
| 10 December 2003 (ETD Cape Town 14:00) | 25 December 2003 ETA - Antarctica | Voyage to Antarctica | 15 Days |
| Blank | 15 December 2003 (Bouvet Island) | Service of AWS (Norwegian) Back load of cargo | 24 Hours |
| 16 December 2003 (Bouvet Island) | Blank | Depart to Norwegian off-loading point (5 Deg East) | Approximately 5 days Sailing |
| | 21 December 2003 (ETA 5 Deg East) | Off-load approx 42 tons of Norwegian cargo | 48 Hours |
| 23 December 2003 (Depart for SANAE) | 25 December 2003 (Arrive at SANAE) | Blank | 2 Days |
| | 25 December 2003 - 07 January 2004 (SANAE) | Off-load cargo Off-load personnel Pump fuel | 14 Days |
| 08 January 2004 (ETD SANAE) | 18 January 2004 (ETA SANAE) | SAWB buoy deployment South Sandwich Islands | 10 days |
| | 18 January 2004 to 8 - 10 February 2004 | Back-load cargo Pump fuel Back-load passengers | 20 - 22 days |
| 8 - 10 February 2004 (ETD SANAE) | 18 February 2004 (ETA Cape Town) | Voyage to Cape Town | 8 - 10 Days |

TOTAL DURATION OF RELIEF VOYAGE:

TOTAL: 71 DAYS

PASSENGER CABIN ALLOCATION

VOYAGE NUMBER : 114

FROM : Cape Town TO : Antarctica

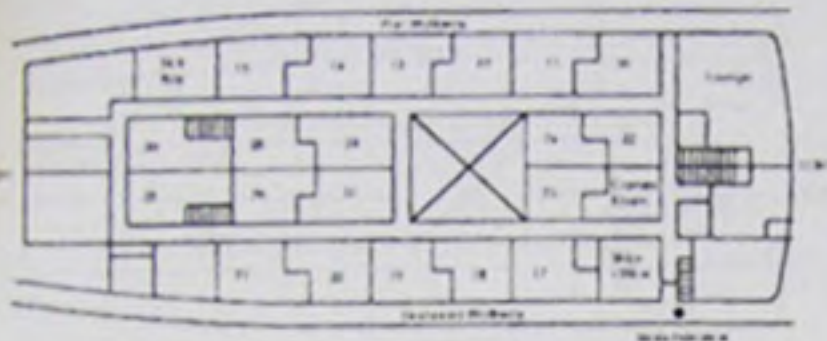
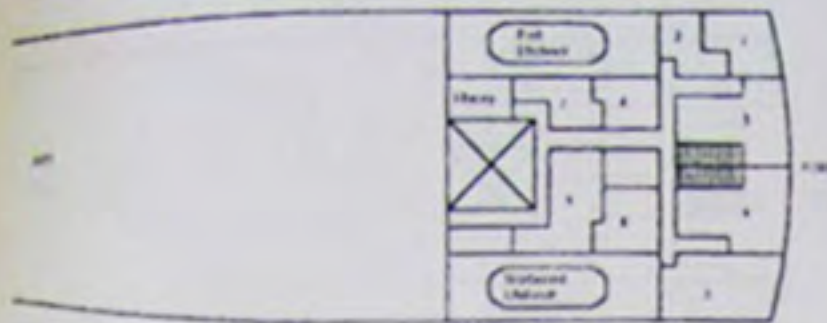

| No | NAME | No | NAME | No | NAME | No | NAME | |
|----|----------------------|----|------------------|----|---------------|----|----------------------|------------|
| 1 | a S. Durand | 10 | a B. de Wet | 17 | a T. Kuipers | 24 | a P. J. Bezuidenhout | |
| | b C. Hanel | | b M. Welgemoed | | b J. de Preez | | b | |
| 2 | a D. Hendrikse | | c | | c | c | 25 | a R. Lewis |
| | a G. Sproul | | d | | d | d | | b |
| 3 | b J. Redelinghuys | 11 | a P. Wolmerans | 18 | a F. Boekkooi | 26 | a J. Skelete | |
| | c | | b S. Cockcroft | | b E. Rice | | b L.S.D. du Plessis | |
| | d | | c S. Terblanche | | c J. Sindin | | c G. Harper | |
| | | | d | | d | | d | |
| 4 | a J. Pietersen | 12 | a L. Engelbrecht | 19 | a P. Jacobs | 27 | a A. Masshilo | |
| | b D. Windwaai | | b D. Govias | | b Y. Samuel | | b J. Taljaard | |
| | c | | c M. Loubser | | c M. Xalagube | | c A. Kietzmann | |
| | d | | d | | d | | d | |
| 5 | a A. van Niekerk | 13 | a V. Rinquest | 20 | a P. Zaayman | 28 | a L. du Plessis | |
| | b F. Hoffmann | | b E. Williams | | b L. le Roux | | b R. Muscheler | |
| | c | | c H. Smith | | c G. Dreyer | 29 | a A. Mans | |
| | d | | d | | d | | b | |
| 6 | a Dr. R. Niemand | 14 | a R. Bassadien | 21 | a D. van Zyl | 30 | a Medical Technician | |
| | b Doctor's Cabin | | b R. Salie | | b S. Ndaba | | b Z. Botha | |
| 7 | a B. Bell | | c C. Nel | | c J. Gouvias | | c | |
| | a Prof. A. Hussin | | d | | d | | d | |
| 8 | b Mr. A. Ahmad | 15 | a A. Damster | 22 | a N. Meyer | 31 | a | |
| | a J. T. Johansen | | b J. Frost | | b E. Mathys | | b | |
| | b M. Ø. Mikelborg | | c A. Strumpher | a | c | | | |
| | c J. Mäkinen | | d | b | d | | | |
| 9 | d J.R. van der Merwe | | | | | | | |

PASSENGER CABIN ALLOCATION

VOYAGE NUMBER: 114

FROM Antarctica TO: Cape Town

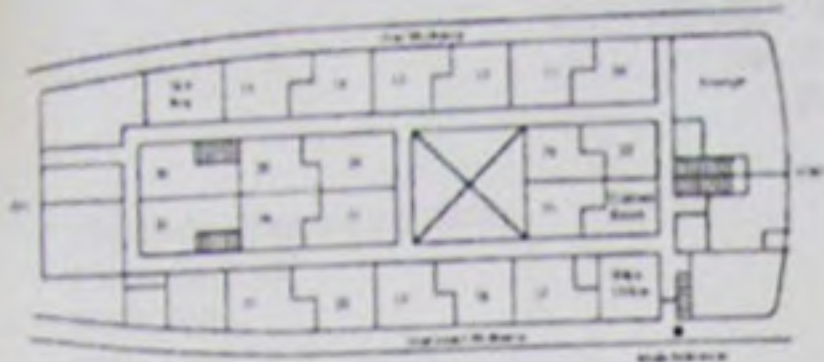
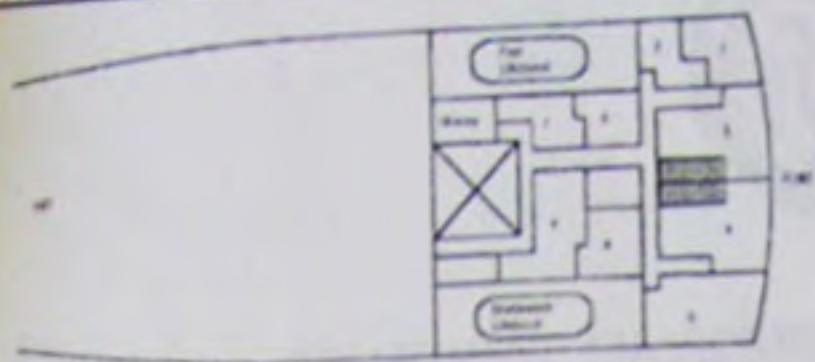

| No | NAME | No | NAME | No | NAME | No | NAME | |
|----|----------------------|----|-------------------------|----|---------------|----|----------------------|------------|
| 1 | a S. Durand | 10 | a D. Ritchie | 17 | a T. Kuipers | 24 | a P. J. Bezuidenhout | |
| | b C. Hanel | | b J. van Rooyen | | b J. de Preez | | b | |
| 2 | a D. Hendrikse | | c K. Steyn | | c | c | 25 | a R. Lewis |
| | a G. Sproul | | d | | d | d | | b |
| 3 | b J. Redelinghuys | 11 | a N. Janse van Rensburg | 18 | a F. Boekkooi | 26 | a J. Skelete | |
| | c | | b J. Bijker | | b E. Rice | | b L.S.D. du Plessis | |
| | d | | c E. Ferreira | | c J. Sindin | | c G. Harper | |
| | a J. Pietersen | | d | | d | | d | |
| 4 | b D. Windwaai | 12 | a T. Nyembe | 19 | a P. Jacobs | 27 | a A. Masshilo | |
| | c | | b V. Masodo | | b Y. Samuel | | b J. Taljaard | |
| | d | | c | | c M. Xalagube | | c A. Kietzmann | |
| | a A. van Niekerk | | d | | d | | d | |
| 5 | b F. Hoffmann | 13 | a V. Rinquest | 20 | a P. Zaayman | 28 | a L. du Plessis | |
| | c | | b E. Williams | | b L. le Roux | | b R. Muscheler | |
| | d | | c H. Smith | | c G. Dreyer | 29 | a A. Mans | |
| | a Dr. M. Sekgala | | d | | d | | b | |
| 6 | b Doctor's Cabin | 14 | a R. Bassadien | 21 | a D. van Zyl | 30 | a Medical Technician | |
| | a B. Bell | | b R. Salie | | b S. Ndaba | | b Z. Botha | |
| 7 | a Prof. A. Hussin | | c C. Nel | | c | | c J. Gouvias | c |
| | b Mr. A. Ahmad | | d | | d | | d | d |
| 8 | a J. P. Hoiyas | 15 | a A. Damster | 22 | a N. Meyer | 3 | a | |
| | b J.R. van der Merwe | | b J. Frost | | b E. Mathys | | b | |
| | c | | c A. Strumpher | a | c | | | |
| | d | | d | 23 | b | 1 | d | |