

# S.A AGULHAS ACCOMMODATION

MARION OCEANOGRAPHIC CRUISE CABIN ALLOCATIONS

VOYAGE NO: 116

HELICOPTER DECK

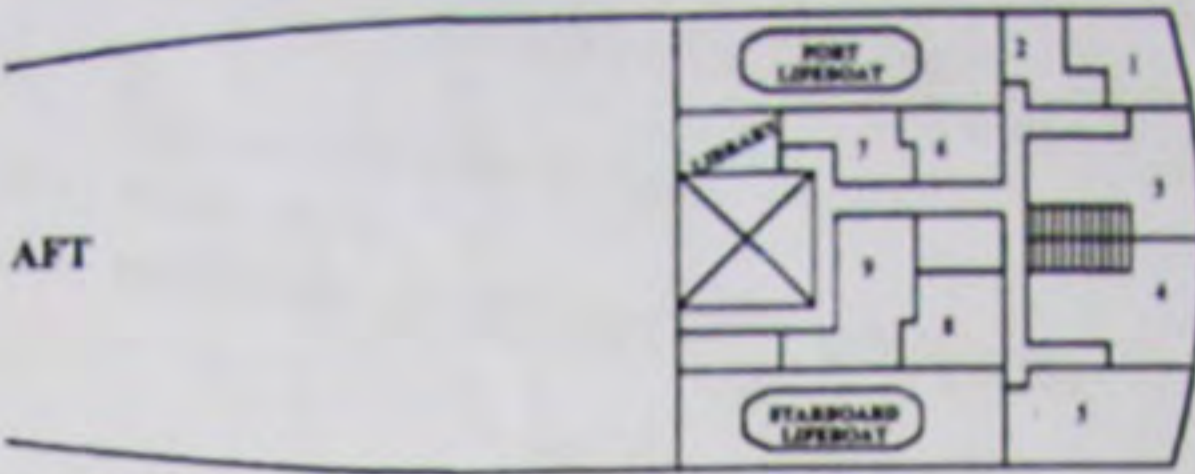

UPPER DECK

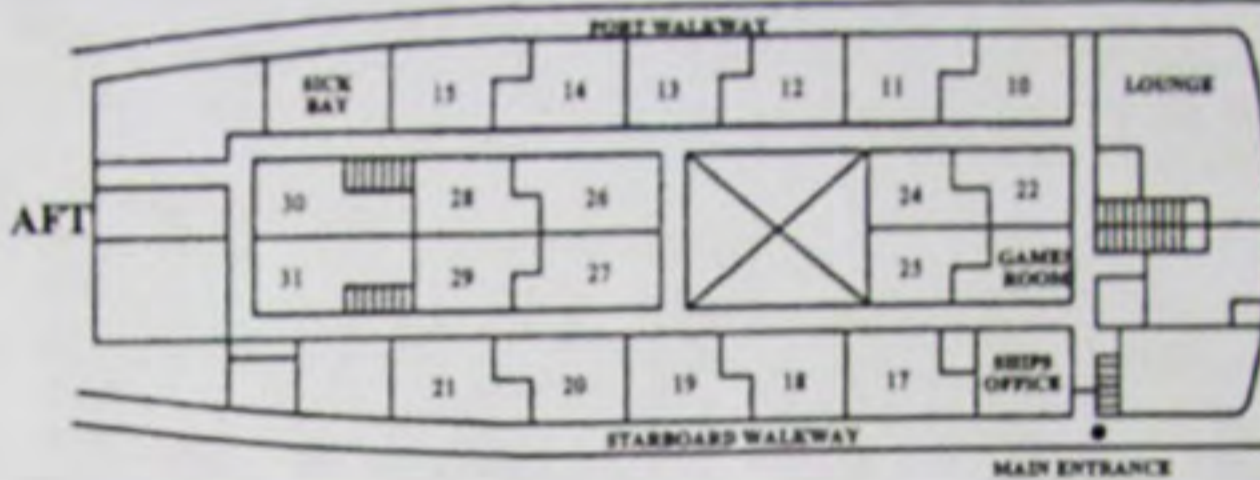

CAB No	BERTH No	NAME	CAB No	BERTH No	NAME	CAB No	BERTH No	NAME	CAB No	BERTH No	NAME		
1	A	P FOLEY	10	A	N BURLS	17	A	J BRITTON	25	A	J BROPHY		
	B			B			B	B SHAW		B			
2	A	J POCOCK		C			18	C			26	A	L LANGE
	3	A		C KOK	D					D			B
4		B	T ROUX	11	A	S GILDENHUYS		A	J BLAKE	27		C	
	C		B			B		R GERBER	D				
	D		C			C		A	D SOUTHEY				
	A	W FRONEMAN	D			D		B					
5	B		12	A	T MANZONI	19	A	M D COLEMAN	28	C			
	C			B			B			D			
	D			C			C			A	S BLAND		
	A	I ANSORGE		D			D			B			
6	B		13	A	D RENSBURG	20	A	S WYNNE	29	A	A LUDFORD		
	C			B	B BACKEBERG		B			B			
	D			C			C			A			
	A	DR VD WESTHUIZEN		D			D			B			
7	B		14	A	E ROBERTSON	21	A	D LUKAC	30	C			
	8	A		D HILLAND	B			B			D		
9		A		D FERREIRA	C			C			31	A	
	B			D			D			B			
9	A	A STROEBEL	15	A	K BERNARD	22	A	S SWART	C				
	B	B QUICKFALL		B			B		D				
	C			C			23	CATERING OFFICER					
	D			D				24	A	A BERNARD			
		16	SHIPS OFFICE		B								

**PRELIMINARY PASSENGER LIST****CAPE TOWN TO MARION ISLAND - 1 APRIL 2004****Department of Environmental Affairs and Tourism**

Departmental Co-ordinator	- Mr. J. A. Dreyer
Assistant Departmental Co-ordinator	- Ms S. Durand
Chief Industrial Technician	- Mr. F. Hoffmann
Admin Officer	- Mr. S. Watson
Chef	- Mr. D. Cooper
Chef	- Mr. C. Heroldt
Medical Doctor	- Dr S. Isaacs ( <i>Ship-based</i> )

**Department of Public works**

Mr. M. Murphy	- ( <i>Group Leader New Base Project</i> )
Mr. G. Hardenberg	- ( <i>Group Leader Maintenance</i> )
Mr. G. Ellis	
Mr. A. Rocha	
Mr. A. Abrahams	
Mr. A. Hendricks	
Mr. H. van der Westhuizen	
Mr. J. J. Links	
Mr. D. du Toit	
Mr. P. Base	
Mr. T. Lala	
Mr. G. Hendricks	
Mr. M. Mahe	
Mr. M. Porta Nova	
Mr. N. Dike	
Mr. N. Nomsentse	
Mr. M. Engels	

**CHC Helicopter Contingent (*Ship-based*)**

Capt. H. R. Hilland	- ( <i>Group Leader</i> )
Capt J. M. Pocock	
Capt B. Quickfall	
F/O A. Stroebel	
Eng J. Britton	
Eng G. Shaw	
R/F T. Roux	
E/A J. Brophy	
F/E K. Kok	

**South African Weather Services**

Mr. D. Ferreira	- ( <i>Group Leader</i> )
-----------------	---------------------------

**Scientists (Island based)**

**University of Pretoria**

- Dr B. S. Steward
- Mr. P. N. Odendaal
- Dr I. Meiklejohn - (Group Leader)
- Dr C. Sjunneskog
- Ms H. Rídefelt
- Mr. B. van der Merwe

**University of Stellenbosh**

- Mr. R. Mercer - (Group Leader)
- Prof H. P. Leinaas
- Dr B. van Vuuren
- Dr M. Somers
- Ms S. Slabber
- Ms N. Netshilaphala
- Mr. L. Jacobs
- Ms T. Khoza
- Mr. P. C. le Roux - (Group Leader)
- Mr. M. J. Nyakatya
- Prof V. R. Smith - (Group Leader)
- Prof L. Mucina
- Prof S. L. Chown - (Group Leader) Chief Island-based Scientist
- Dr B. Sinclair
- Dr R. Worland
- Ms S. Goldberg

**University of Cape Town**

- Ms M. S. de Villiers - (Group Leader) Conservation Officer

**University of the Western Cape**

- Ms J. Rapley - (Group Leader)

**NRF**

- Dr W. L. Combrinck - (Group Leader)
- Mr. P. Stronkhorst

**Marine and Coastal Management**

- Mr. B. Dyer - (Group Leader)
- Mr. W. Chivell

## Oceanographic Scientists (Ship-based)

### University of Cape Town

Dr I. Ansoorge - (Group Leader) Chief Ship-based Scientist  
Ms S. G. Bland  
Ms N. J. Burtis  
Ms S. Gildenhuys  
Ms T. Manzoni  
Ms E. J. Robertson  
Ms D. Southey  
Mr. B. C. Backeberg  
Mr. S. Swart  
Mr. D. van Rensburg  
Mr. P. Foley

### Rhodes University

Dr P. W. Froneman - (Group Leader)  
Ms K. Bernard  
Mr. M. Coleman  
Ms L. Lange  
Ms D. Lucac  
Mr. A. Bernard  
Ms S. Wynne  
Mr. R. Gerber  
Mr. A. Ludford  
Mr. J. Blake

### Marion 61 Team (To over-winter on Marion Island)

Medical Orderly	- Ms R. Viljoen	(Team Leader)
Radio Technician	- Mr. E. Ferreira	
Diesel Mechanic	- Mr. C. Swanepoel	
Senior Meteorologist	- Mr. B. Perks	
Meteorologist	- Mr. A. Mattala	
Meteorologist	- Mr. T. Naledi	
Field Assistant	- Mr. D. Hedding	
Field Assistant	- Mr. J. Ramunasi	
Field Assistant	- Ms M. Bause	
Field Assistant	- Mr. H. Tshithabane	
Field Assistant	- Mr. K. Qwede	
Field Assistant	- Mr. D. Tsungana	
Field assistant	- Mr. S. Abraham	
Field Assistant	- Ms Z. Buwa	
Field Assistant	- Ms E. Turner	

### Marion 60 Team (To return to RSA)

Diesel Mechanic	- Mr. N.T. Green	(Team Leader)
Radio Technician	- Mr. L. Maree	
Senior Meteorologist	- Mr. S.S. Motseto	
Meteorologist	- Mr. M.E. Mamabolo	

Meteorologist  
 Field Assistant  
 Field Assistant  
 Medical Orderly  
 Field Assistant  
 Field Assistant  
 Field Assistant

- Ms S. Linnerts
- Ms E. Nortje
- Mr. B.E. Hanise
- Mr. S. Miles
- Mr. F.M. Muryai
- Mr. N. De Bruyn
- Mr. G. Hofmeyer

VOYAGE E - MARION 204

Total Participants en-route - 98 PASSENGERS  
 Total Participants return voyage - 94 PASSENGERS

Activity	Start Date	End Date	Description	Duration
Departure	11 April 74	11 April 74	Departure from Cape Town	4 Days
Arrival	15 April 74	15 April 74	Arrival at Marion Island	4 Days
Research	16 April 74	22 April 74	Research activities on Marion Island	7 Days
Departure	23 April 74	23 April 74	Departure from Marion Island	4 Days
Arrival	27 April 74	27 April 74	Arrival at Cape Town	4 Days

The above dates are subject to change. All dates pertaining to passengers are subject to the final arrangements which will be determined by the ship's command and reported to the ship's command.

DURATION OF VOYAGE 35 DAYS  
 (Cape Town to Cape Town)

AVAILABLE TIME ON MARION ISLAND 27 DAYS

PASSENGERS TIME ON SA ALUHAS 4 DAYS DOWN  
 4 DAYS RETURN

SHIP'S SEA TIME 35 DAYS

SHIP'S SEA TIME FOR RESEARCH 4 DAYS

## VOYAGE SCHEDULE - MARION 2004

### SA AGULHAS

DEPART	ARRIVE	ACTION	DURATION
27/28 March '04	Pump fuel (for Marion)		
24 - 31 March '04	Load cargo		
1 April '04 ETD at 14:00 Cape Town Harbour Quay 500	± 5 April '04 ETA Marion Island	Voyage to Marion Island	4 Days
± 5 April '04 - 2 May '04	Take-over period	Discharge personnel and cargo Pump fuel Carry out all take-over tasks/projects Load cargo and personnel	27 Day take-over
± 12 April '04 ETD Marion Island	± 26 April '04 ETA Marion Island	Oceanographic research cruise	Maximum 14 Day cruise
± 3 May '04 ETD Marion Island	7 May '04 ETA Cape Town Harbour Quay 500	Voyage to Cape Town	4 Days

Dates and times are subject to change. All detail pertaining the scientific as well as the logistic programmes/projects/tasks for the duration of the voyage/take-over period are stipulated in the official Take-over Manual.

**DURATION OF VOYAGE  
(Cape Town to Cape Town)**

**36 DAYS**

**AVAILABLE TIME ON MARION ISLAND**

**27 DAYS**

**PASSENGERS TIME ON SA AGULHAS**

**4 DAYS DOWN  
4 DAYS RETURN**

**SHIP'S SEA TIME**

**36 DAYS**

**SHIP'S SEA TIME FOR RESEARCH**

**4 DAYS**

# PASSENGER CABIN ALLOCATION

Annexure C

VOYAGE NUMBER: 116

FROM: Cape Town TO: Marion Island

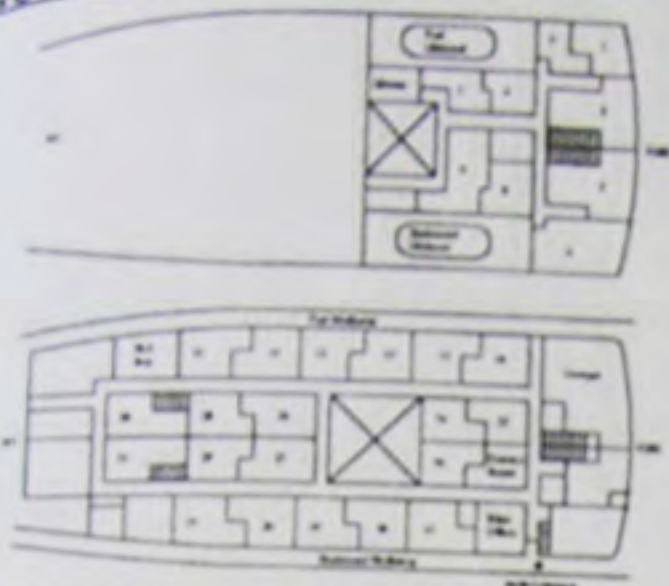

**NOTE: BERTHS ON THE OFFICERS DECK FOR:**

- 1) MR. F. HOFFMANN
- 2) MR. S. WATSON

- 1) MR. W. COMBRINCK
- 2) MR. P.C. LE ROUX

No	NAME		No	NAME		No	NAME				
1	a	S. CHOWN	10	a	B. PERKS	17	a	K. KOK			
	b	R. MECER		b	A. MATLALA		b	T. ROUX			
2	A	A. DREYER		c	D. HEDDING		c	G. SHAW	24	a	I. MEKLEJOHN
	a	V. SMITH		d	J. RAMUNASI		d	J. BROPHY		b	B. VD MERWE
3	b	B. DYER	11	a	T. NALEDI	18	a	N. J. BURLS	25	a	D. COOPER
	c	B. STEWARD		b	M. BAUSE		b	S. GILDENHUIS		b	C. HEROLDT
	d	L. MUCINA		c	E. TURNER		c	T. MANZONI		a	S. WYNNE
	a	W. FRONEMAN		d	Z. BUWA		d	E. J. ROBERTSON		b	S. SLABBER
4	b	P. FOLEY	12	a	H. TSHITHABANE	19	a	S. G. BLAND	26	c	N. NETSHLAPHALA
	c	S. SWART		b	K. QWEDE		b	D. SOUTHEY		d	T. KHOZA
	d	D. FERREIRA		c	D. TSINGANA		c	J. RAPLEY		a	A. BERNARD
	a	I. ANSORGE		d	S. ABRAHAM		d	S. GOLDBERG		b	R. GERBER
5	b	S. DURAND	13	a	B. C. BACKEBERG	20	a	A. ROCHA	27	c	A. LUDFORD
	c	M. DE VILLIERS		b	D. VAN RENSBURG		b	D. DU TOIT		d	W. CHIVELL
	d	B. V. VUUREN		c	B. SINCLAIR		c	M. PORTA NOVA		a	G. ELLIS
	a	Dr. S. ISAACS		d	P. STRONKHORST		d	H. VD WESTHUIZEN		b	P. BASE
6	b	R. V. VILJOEN	14	a	J. BLAKE	21	a	A. ABRAHAMS	28	a	C. SJUNNESKOG
	7	a		H. R. HILLAND	b		H. P. LEINAAS	b		J. J. LINKS	b
8		a		M. MURPHY	c		M. SOMERS	c		A. HENDRICKS	a
	b	G. HARDENBERG		d	L. JACOBS		d	G. HENDRICKS		b	N. DIKE
9	a	J. M. POCOCK	15	a	K. BERNARD	22	a	E. FERREIRA	30	c	M. MAHE
	b	B. QUICKFALL		b	M. COLEMAN		b	C. SWANEPOEL		d	T. LALA
	c	A. STROEBEL		c	L. LANGE		a	Pursers		a	P. ODENDAAL
	d	J. BRITTON		d	D. LUCAC		b	Cabin		b	M. ENGELS
									c	M. NYAKATYA	
									d	R. WORLAND	

## PASSENGER CABIN ALLOCATION

VOYAGE NUMBER:

116

FROM Marion Island

TO:

Cape Town

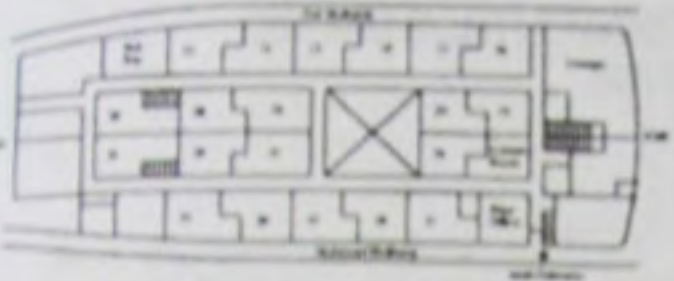
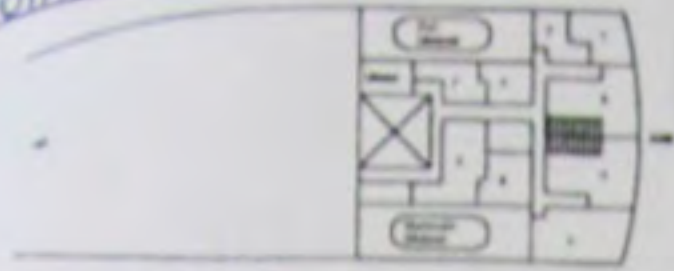

No	NAME		No	NAME		No	NAME		No	NAME	
1	a	S. CHOWN	10	a	B. HANSE	17	a	K. KOK	24	a	I. MERLEJOHN
	b	R. MECER		b	E. MAMABOLO		b	T. ROUX		b	B. VD MERWE
2	A	A. DREYER		c	S. MOTSETO		c	G. SHAW	25	a	D. COOPER
	a	V. SMITH		d	M. MUNYAI		d	J. BROPHY		b	C. HEROLDT
3	b	B. DYER	11	a	N. GREEN	18	a	N. J. BURLS	26	a	S. WYNNE
	c	B. STEWARD		b	L. MAREE		b	S. GILDENHUIS		b	B. SLABBER
	d	L. MUCINA		c	N. DE BRUYN		c	T. MANZON		c	N. NETSHLAPHALA
	a	W. FRONEMAN		d	G. HOFMEYR		d	E. J. ROBERTSON		d	T. KHOZA
4	b	F. HOFFMANN	12	a	P. FOLEY	19	a	S. G. BLAND	27	a	A. BERNARD
	c	S. WATSON		b	S. SWART		b	D. SOUTHEY		b	R. GERBER
	d	D. FERREIRA		c	D. VAN RENSBURG		c	J. RAPLEY		c	A. LUDFORD
	a	I. ANSORGE		d	B. C. BACKEBERG		d	S. GOLDBERG		d	W. CHIVELL
5	b	S. DURAND	13	a	P.C. LE ROUX	20	a	A. ROCHA	28	a	G. ELLIS
	c	M. DE VILLIERS		b	W. COMBRINCK		b	D. DU TOIT		b	P. BASE
	d	B. V. VUUREN		c	B. SINCLAIR		c	M. PORTA NOVA	29	a	C. SJUNNESKOG
	a	Dr. S. ISAACS		d	P. STRONKHORST		d	H. VD WESTHUIZEN		b	H. RIDEFELT
6	b	S. MILES	14	a	J. BLAKE	21	a	A. ABRAHAMS	30	a	N. NOMSENTSE
	a	H. R. HILLAND		b	H. P. LEINAAS		b	J. J. LINKS		b	N. DIKE
8	a	M. MURPHY		c	M. SOMERS		c	A. HENDRICKS		c	M. MAHE
	b	G. HARDENBERG		d	L. JACOBS		d	G. HENDRICKS		d	T. LALA
9	a	J. M. POCOCK	15	a	K. BERNARD	22	a	E. NORTJE	31	a	P. ODENDAAL
	b	B. QUICKFALL		b	M. COLEMAN		b	S. LINNERTS		b	M. ENGELS
	c	A. STROEBEL		c	L. LANGE	23	a	Purser		c	M. NYAKATYA
	d	J. BRITTON		d	D. LUCAC		b	Cabin		d	R. WORLAND