

# PASSENGER CABIN ALLOCATION

VOYAGE NUMBER: 115

FROM: Neumayer TO: Capetown

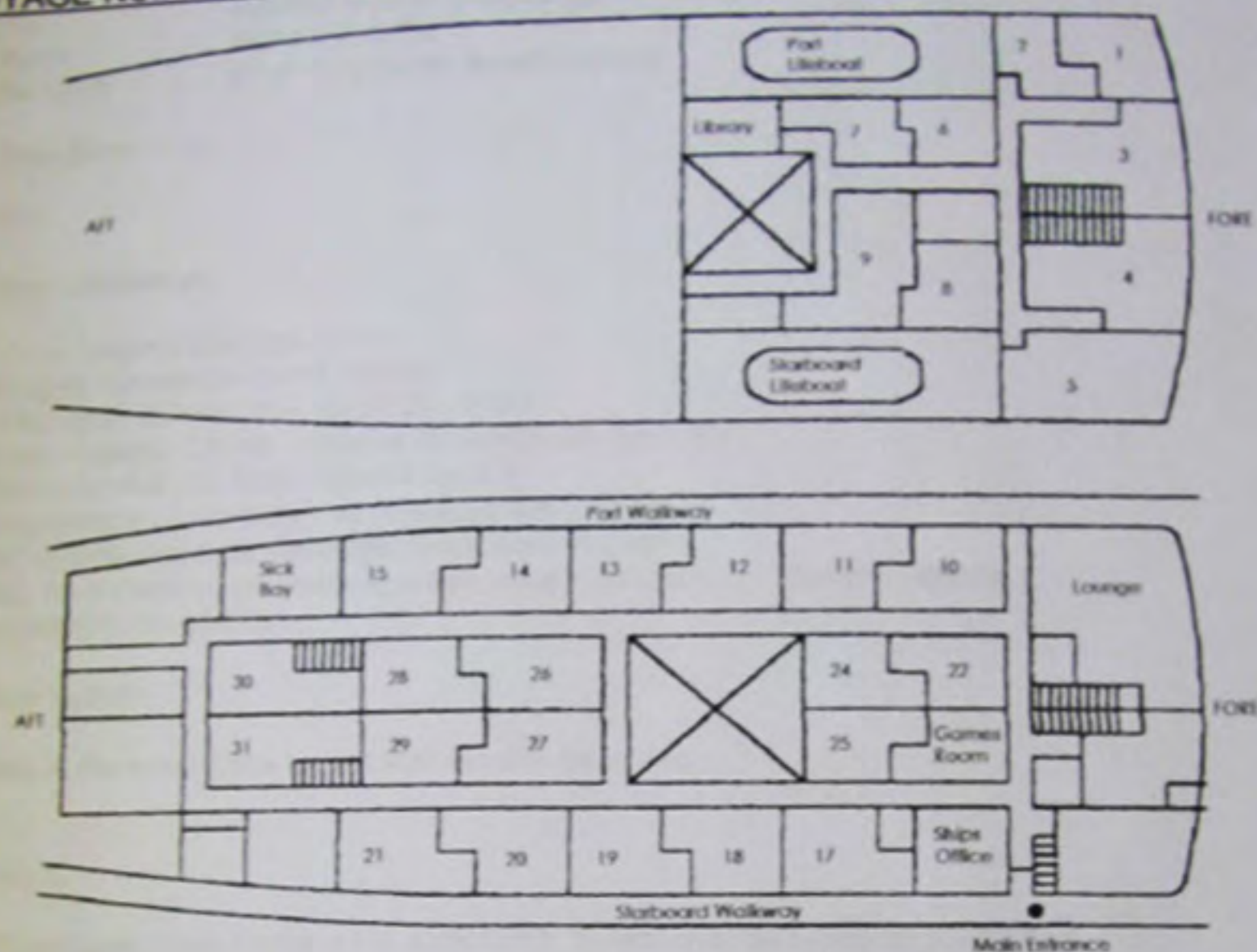

No	NAME		No	NAME		No	NAME					
1	a	Ahammer	10	a		17	a					
	b			b	I. Ansorge		b	Brehme	24	a		
2	a	Janneck		c			c	Köhler	25	a	Wuttke	
				d			d			b		
3	a		11	a		18	a		26	a		
	b	Weynand		b	H. Rautenbach		b	Ackermann		b		
	c	Schubert		c			c			c		
	d			d			d			d		
4	a		12	a		19	a		27	a		
	b	M. Pieterse		b	P. Foley		b	Normann		b		
	c			c			c	Weidt		c		
	d			d			d			d		
5	a		13	a		20	a		28	a		
	b	J. Armstrong		b	J. Kemp		b	Käbbohrer		b		
	c			c			c	Müller		29	a	Krischat
	d			d			d				b	
6	a	D. Garish	14	a		21	a		30	a		
	b			b	H. Grobler		b	Wauer		b		
7	a	Drücker		c			c			c		
				d			d			d		
8	a		15	a		22	a		31	a		
	b	K. Booyse		b	S. Leizour		b			b		
9	a			c			23	a			c	
	b	Ramson		d				b			d	
	c	Schumann										
	d											

SAILING INSTRUCTIONS VOYAGE 115 TO NEUMAYER  
25 FEBRUARY 2004 TO 18 MARCH 2004-02-24  
ADDENDUM

This is to confirm that no one is allowed to go ashore at Neumayer Station or onto the ice shelf in the Atka Bukta.

The only person permitted to go onto the ice shelf or to visit the Neumayer Station on invitation, is the DCO for the voyage, Mr JJ Booyse of the Department of Environmental Affairs and Tourism.

Participants of the Good Hope Line oceanographic programme have no business at the Neumayer Station.

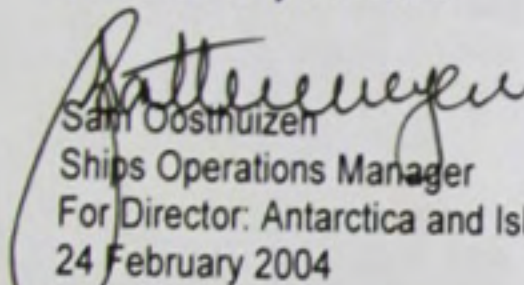
  
Sam Oosthuizen  
Ships Operations Manager  
For Director: Antarctica and Islands  
24 February 2004